

SENDIX 5868/5888, OPTYCZNY, WIELOBROTOWY, PROFINET, Ø58 MM

Enkodery wielobrotowe absolutne optyczne

SERIE 5868 PROFINET

- Średnica zewnętrzna: Ø 58 mm
- Maks. średnica wałka: Ø 10 mm. Maks. średnica otworu: Ø 15 mm
- aks. rozdzielczość: 16 bitów ST + 12 bitów MT
- PROFINET IO
- Safety-Lock™



OPIS PRODUKTU

Sendix 5868/5888 is a multivariate sensor with Profinet in robust design. Thanks to the construction of Safety-Lock™ as well as the fully cast housing, the sensor is able to handle even the more demanding applications where there are high demands on the sensor. The wide temperature range combined with the high enclosure class allows the sensor to be used outdoors as well as applications where large temperature changes occur.

W celu określenia numeru katalogowego proszę o zapoznanie się z poniższymi informacjami.

Order code	8.5868 . XXC2 . C2 12				
Shaft version	Type	a	b	c	e
a Flange					
1 = clamping flange, IP65 ø 58 mm [2.28"]					
3 = clamping flange, IP67 ø 58 mm [2.28"]					
2 = synchro flange, IP65 ø 58 mm [2.28"]					
4 = synchro flange, IP67 ø 58 mm [2.28"]					
5 = square flange, IP65 □ 63.5 mm [2.5"]					
7 = square flange, IP67 □ 63.5 mm [2.5"]					
b Shaft (ø x L), with flat					
1 = 6 x 10 mm [0.24 x 0.39"] ¹⁾					
2 = 10 x 20 mm [0.39 x 0.79"] ²⁾					
3 = 1/4" x 7/8"					
4 = 3/8" x 7/8"					
c Interface / power supply					
C = PROFINET IO / 10 ... 30 V DC					
d Type of connection					
removable bus terminal cover					
2 = 3 x M12 connector, 4-pin					
e Fieldbus profile					
C2 = PROFINET IO					
					Optional on request
					- Ex 2/22
					- surface protection salt spray tested

Order code	8.5888 . XXC2 . C2 12				
Hollow shaft	Type	a	b	c	e
a Flange					
1 = with spring element, long, IP65					
2 = with spring element, long, IP67					
3 = with stator coupling, IP65 ø 65 mm [2.56"]					
4 = with stator coupling, IP67 ø 65 mm [2.56"]					
5 = with stator coupling, IP65 ø 63 mm [2.48"]					
6 = with stator coupling, IP67 ø 63 mm [2.48"]					
b Blind hollow shaft					
(insertion depth max. 30 mm [1.18"])					
3 = ø 10 mm [0.39"]					
4 = ø 12 mm [0.47"]					
5 = ø 14 mm [0.55"]					
6 = ø 15 mm [0.59"]					
8 = ø 3/8"					
9 = ø 1/2"					
c Interface / power supply					
C = PROFINET IO / 10 ... 30 V DC					
d Type of connection					
removable bus terminal cover					
2 = 3 x M12 connector, 4-pin					
e Fieldbus profile					
C2 = PROFINET IO					
					Optional on request
					- Ex 2/22
					- surface protection salt spray tested

SPECYFIKACJA TECHNICZNA

Max. temperatura pracy	85 °C
Min. temperatura pracy	-40 °C
Montaż	Wał
Napięcie zasilania DC max.	30 V DC

Napięcie zasilania DC min.	10 V DC
Podłączenie	Złącze M12
Resolution Overall	28 bit (default 25 bit)
Rozdzielczość MT	Max. 12 bit
Rozdzielczość ST	16 bit (default 13 bit)
Średnica obudowy	58 mm
Średnica wału max	10 mm
Średnica wału min	6 mm
Stopień ochrony IP	IP65, IP67
Typ czujnika	Absolutny
Wersja	Wielobrotowy
Wyjście	ProfiNet

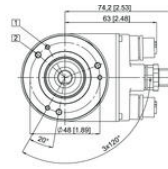
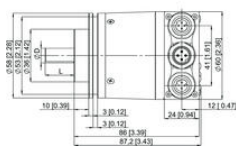
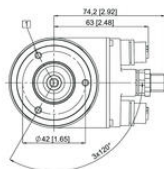
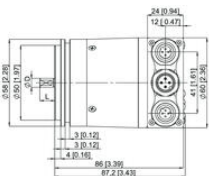

Interface	Type of connection	Function	M12 connector				Pin		
C	2 (3 x M12 connector)	Bus port 1	Signal:	Transmit data	Receiver data	Transmit data	Receiver data	1	2
		Abbreviation:	TxD+	RxD+	TxD-	RxD-	4	3	
		Pin:	1	2	3	4	4	3	
		Power supply	Signal:	Voltage +	-	Voltage -	-	4	3
		Abbreviation:	+V	-	0V	-	4	3	
		Pin:	1	2	3	4	1	2	
		Bus port 2	Signal:	Transmit data	Receiver data	Transmit data	Receiver data	1	2
		Abbreviation:	TxD+	RxD+	TxD-	RxD-	4	3	

Interface	Type of connection	Function	M12 connector				Pin		
C	2 (3 x M12 connector)	Bus port 1	Signal:	Transmit data	Receiver data	Transmit data	Receiver data	1	2
		Abbreviation:	TxD+	RxD+	TxD-	RxD-	4	3	
		Pin:	1	2	3	4	4	3	
		Power supply	Signal:	Voltage +	-	Voltage -	-	4	3
		Abbreviation:	+V	-	0V	-	4	3	
		Pin:	1	2	3	4	1	2	
		Bus port 2	Signal:	Transmit data	Receiver data	Transmit data	Receiver data	1	2
		Abbreviation:	TxD+	RxD+	TxD-	RxD-	4	3	